



# SOUNDSTAGE 10

Susan Sontag

A stage adaptable to any project

## 10468.54 SQ FEET

HEIGHT FROM FLOOR TO LIGHTING GRID: 26.24 SQ FEET

11,342.47 sq feet

3,188.16 sq feet

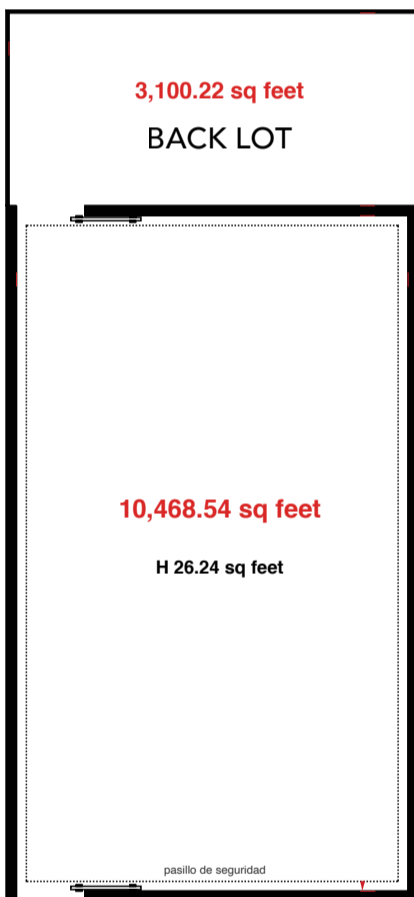

### TECHNICAL SPECS

- Exclusive access**
- Elephant Doors** and Pedestrian Doors
- Electrified grid** (Supports up to 150 kg per m2)
- Beams with hoists** (Each beam supports up to 250kg)
- Catwalks**
- Double wall** and insulating roof
- Acoustic treatment** on floor and walls

### ADDITIONAL SPACES: On the floor

- Exclusive dining space** with sink and bar
- Exclusive area for sanitization** or multipurpose
- 4 Multipurpose spaces**
- Half baths**
- Back lot** or maneuvering space

### ADDITIONAL SPACES: First floor

- 1 room** with acoustic treatment
- 1 make-up room** with 4 coquettes and 2 wash heads
- 7 dressing rooms** with armchairs and mirror
- Half baths**
- VIP room** / living room

### ADDITIONAL IN STAGE 10

- Symmetric dedicated** Internet from 100 mb (extra cost)
- 24 hour surveillance** and CCTV system
- 1 CAM-LOK electrical connection board**
- Installation** to connect air conditioning
- Silent air conditioning** (subject to availability, with extra cost, does not include power plant service)