



SOUNDSTAGE 1

José Ignacio Cabrujas

A soundstage for large-scale projects

11,799.93 sq feet

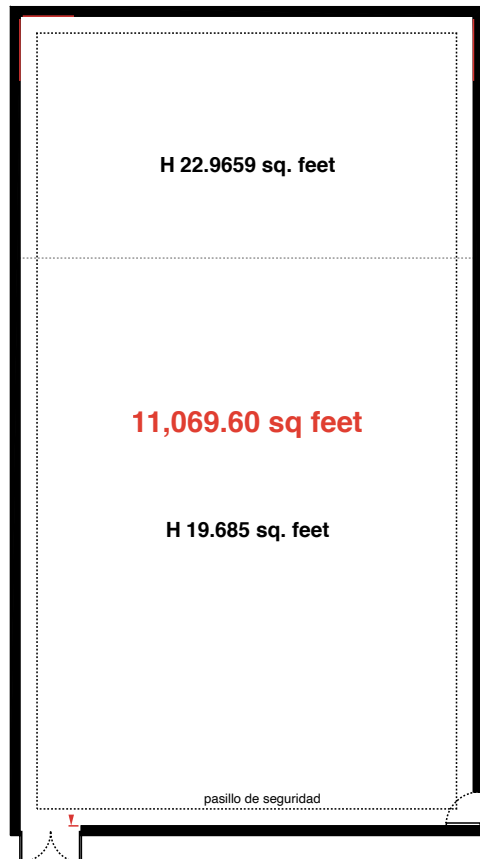

11,069.60 SQ FEET

HEIGHT FROM FLOOR TO LIGHTING GRID:
19.68 SQ FEET AND 22.96 SQ FEET

TECHNICAL SPECS

- Elephant Doors and Pedestrian Doors
- Electrified grid (Supports up to 150 kg per m²)
- Lighting bridge
- Double wall and insulating roof
- Acoustic treatment on floor and walls
- Load center
- Polished and level floor

ADDITIONAL IN STAGE 1

- 7 dressing rooms with bathroom and shower
- 2 make-up rooms with two and three coquettes
- Catering area
- Production offices
- 2 wardrobe warehouses
- Silent air conditioning
- 1200 A electrical substation
- Symmetric dedicated Internet from 100 mb
- Control Room

*extra cost